

Ntensify[®]micro

Ntensify micro quick start guide for 20 mL configuration

Best option for scalable production

! Prior to any run on the Ntensify micro, order the recommended disposables mentioned in the user manual!

Getting started

- To install all the required hardware, unlock the metallic latch (blue box) before screwing in the accessories.
- Use the provided screwdriver (red box) to attach the 20 mL holder.

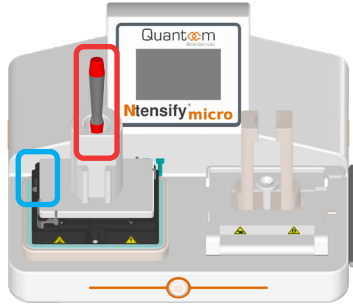

Reagents management

- Store mix 1-4 at -20°C; others at room temperature.
- Keep mix 2 and mix 4 in freezer until use, then on ice during run.
- Condition beads prior to IVT.



Beads conditioning

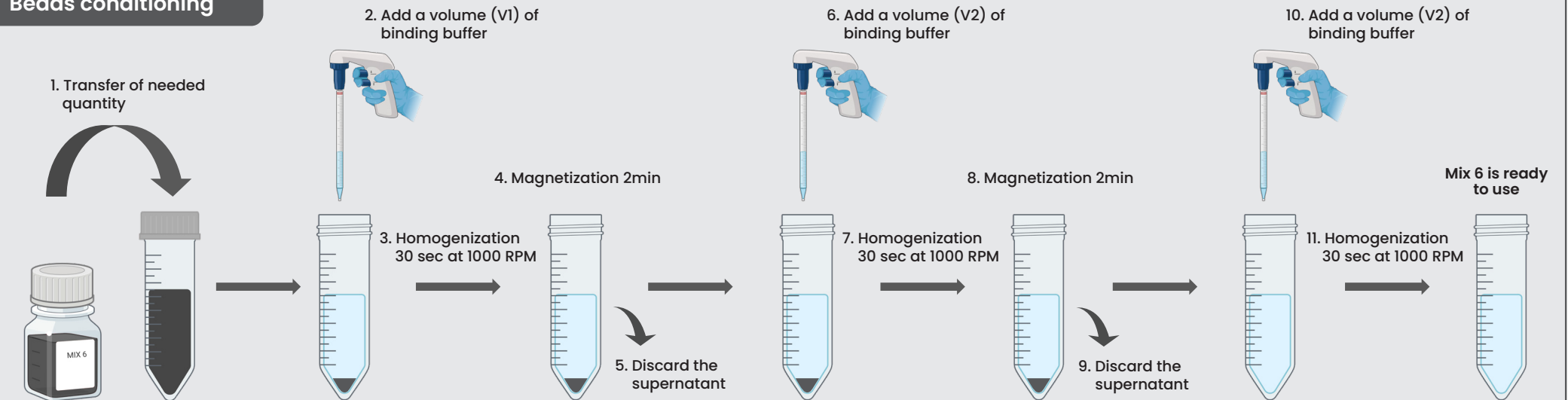

Recommendations

- Ntensify micro requires to follow Good Laboratory Practices
- Ntensify micro software will automatically guide the user in the appropriate bead conditioning

Overview of the process (for a full 20 mL run)

- Ntensify micro's software will guide you throughout the complete workflow
- Respect each programmed timing the Ntensify micro displays on the screen



The buzzer rings after incubation, centrifugation, and run.

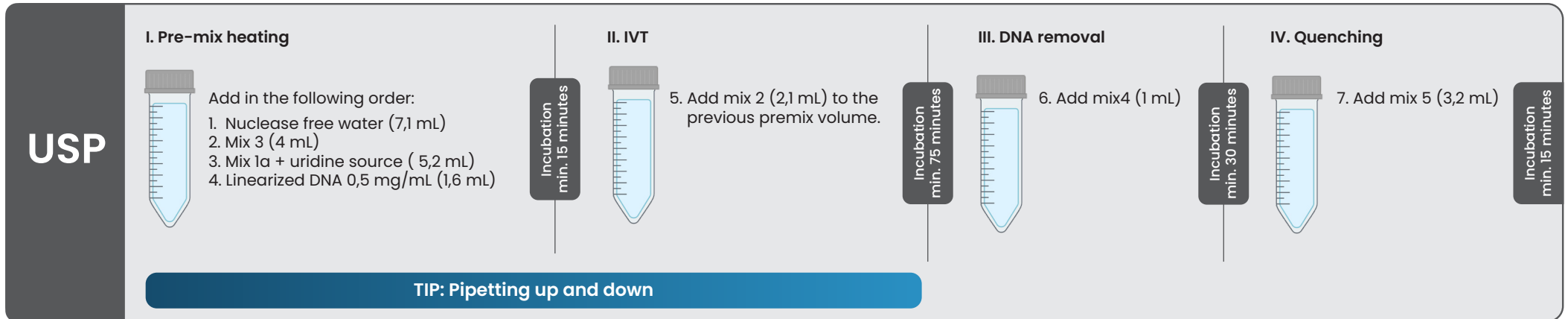

Ethanol 80% should be prepared before DSP

